

REGION IV 5A-6A
FRIDAY, APRIL 28, 2023
8:00 A.M. – Gates will open for the public

6A
AAAAAA Field Events:

	<u>WEIGH-IN TIMES & LOCATION</u>
9:00 am	Boys Pole Vault Girls High Jump Girls Long Jump Girls Discus Boys Shot Put Boys WC Div Boys Triple Jump
	<u>EASTSIDE STORAGE ROOM.</u> 7:00-8:00 am
	<u>HOME TEAM DRESSING ROOM</u> 7:00-8:00 am 7:00-8:00 am
11:30 am	Boys Discus Boys High Jump Boys Long Jump Girls Triple Jump Girls Shot Put Girls WC Div
	<u>HOME TEAM DRESSING ROOM</u> 9:30 -10:30 am
	<u>HOME TEAM DRESSING ROOM</u> 9:30-10:30 am
	<u>EASTSIDE STORAGE ROOM</u> 9:30-10:30 am
	Girls Pole Vault

5A
AAAAA Field Events:

	<u>WEIGH-IN TIMES & LOCATION</u>
2:30pm	Boys Pole Vault Girls High Jump Girls Long Jump Girls Discus Boys Shot Put Boys WC Div Boys Triple Jump
	<u>EASTSIDE STORAGE ROOM</u> 12:30-1:30 pm
	<u>HOME TEAM DRESSING ROOM</u> 12:30-1:30 pm 12:30-1:30 pm
5:00pm	Boys Discus Boys High Jump Boys Long Jump Girls Triple Jump Girls Shot Put Girls WC Div
	<u>HOME TEAM DRESSING ROOM</u> 3:00-4:00 pm
	<u>HOME TEAM DRESSING ROOM</u> 3:00-4:00 pm
	<u>EASTSIDE STORAGE ROOM</u> 3:00-4:00 pm
	Girls Pole Vault

RUNNING EVENTS: AAAAA and AAAAAA GIRLS AND BOYS PRELIMINARIES
3200 METER GIRLS AND BOYS FINALS

Qualifying Procedures:

Prelims: Heat and lane assignments are generated *randomly* by the Hy-Tek computerized program.

Finals : The winner of each heat and the next 6 fastest times will advance to the finals. Lane assignments are based on times run in prelims. (Lanes 4-5-3-6-2-7-1-8)

9:00 a.m. 3200 Meter Run Finals: 5A Girls & Boys followed by 6A Girls & Boys All 5A relay entry cards & scratches due at the Heroes ticket booth.

5A

AAAAA PRELIMS:

- 9:30 a.m.** (5A 4x100 Relays report/uniform check)
- 10:00 a.m.** 4X100 Meter Relay (Girls & Boys)
- 10:30 a.m.** 100 Meter Hurdles (33") (Girls)
- 10:40 a.m.** 110 Meter Hurdles (39") (Boys)
- 10:50 a.m.** 100 Meter Dash (Girls & Boys)
- 11:10 a.m.** 4X200 Meter Relay (Girls & Boys)
- 11:30 a.m.** 400 Meter Dash (Girls & Boys)
- 11:50 a.m.** 300 Meter Hurdles (30") (Girls)
- 12:00 p.m.** 300 Meter Int. Hurdles (36") (Boys)
- 12:10 p.m.** 200 Meter Dash (Girls & Boys)
- 12:30 p.m.** 4X400 Meter Relay (Girls & Boys)

*****THE ABOVE TIMES ARE APPROXIMATE FOR RUNNING PRELIMS.
 *****JUDGE YOUR WARM-UP ON EVENTS, NOT TIMES

REGION IV 5A-6A

FRIDAY, APRIL 28, 2023

CONTINUED

2:30 p.m. All 6A relay entry cards & scratches due at the Heroes ticket booth.

6A

AAAAAA PRELIMS:

3:00 p.m. (6A 4x100 Relays report/uniform check)

3:30 p.m. 4x100 Meter Relay (Girls & Boys)

4:00 p.m. 100 Meter Hurdles (33") (Girls) 110 Meter

4:10 p.m. Hurdles (39") (Boys)

4:20 p.m. 100 Meter Dash (Girls & Boys)

4:40 p.m. 4x200 Meter Relay (Girls & Boys)

5:00 p.m. 400 Meter Dash (Girls & Boys)

5:20 p.m. 300 Meter Hurdles (30") (Girls)

5:30 p.m. 300 Meter Int. Hurdles (36") (Boys)

5:40 p.m. 200 Meter Dash (Girls & Boys)

6:00 p.m. 4X400 Meter Relay (Girls & Boys)

*******THE ABOVE TIMES ARE APPROXIMATE FOR RUNNING PRELIMS.**

*******JUDGE YOUR WARM-UP ON EVENTS, NOT TIMES.**

REGION IV 5A-6A
SATURDAY, APRIL 29, 2023
11:00 A.M. – Gates will open for the public

10:00 a.m. Finals packets will be available at the Heroes ticket booth.

RUNNING EVENTS: AAAAA and AAAAAA GIRLS AND BOYS FINALS

PLEASE NOTE: AAAAA teams will run before AAAAAA teams in the Girls and Boys divisions.

- 12:00 p.m.** (4X100 M Relay report/uniform check)
12:30 p.m. 4X100 Meter Relay (Girls and Boys AAAAA and AAAAAA)
- 12:50 p.m.** 800 Meter Run (Girls and Boys AAAAA and AAAAAA)
- 1:10 p.m.** 100 Meter Low Hurdles (33") (Girls AAAAA and AAAAAA)
1:20 p.m. 110 Meter High Hurdles (39") (Boys AAAAA and AAAAAA)
- 1:30 p.m.** 100 Meter Dash (Girls and Boys AAAAA and AAAAAA)
1:35 p.m. 100 Meter Dash (Girls and Boys AAAAA and AAAAAA Wheelchair Division)
- 1:50 p.m.** 4X200 Meter Relay (Girls and Boys AAAAA and AAAAAA)
- 2:10 p.m.** 400 Meter Dash (Girls and Boys AAAAA and AAAAAA)
2:20 p.m. 400 Meter Dash (Girls and Boys AAAAA and AAAAAA Wheelchair Division)
- 2:35 p.m.** 300 Meter Hurdles (30") (Girls AAAAA and AAAAAA)
2:45 p.m. 300 Meter Int. Hurdles (36") (Boys AAAAA and AAAAAA)
- 2:55 p.m.** 200 Meter Dash (Girls and Boys AAAAA and AAAAAA)
- 3:15 p.m.** 1600 Meter Run (Girls and Boys AAAAA and AAAAAA)
- 3:55 p.m.** 4X400 Meter Relay (Girls and Boys AAAAA and AAAAAA)
- 4:40 p.m.** **AWARDS TO TEAM CHAMPIONS**

TRACK AND FIELD EVENTS GENERAL INFORMATION

- I. Track and Field information packets will include the following items and will be made available at Heroes Stadium Ticket Booth, 4799 Thousand Oaks, San Antonio, TX 78233 on Thursday, April 27, 2023. Packets will be available for pick up between 2:00 pm and 5:00 pm. Packets may also be picked up at the Heroes Stadium Ticket Booth on Friday from 7:30 am to 3:30 pm and Saturday from 10:00 am to 1:00 pm.
- Field Event Entries
 - Schedule of Events
 - 3 coaches passes per school (Full time employees of the school district)
 - Heat and Lane assignments
 - Relay cards
- II. **CONTESTANTS:** *All NFHS and UIL rules will govern the events at the regional meet.*
- A. Team camps are located on the east side of the stadium only.
 - B. Will not be allowed on the track and/or infield before the first call for their event.
 - C. Must remain in the stands when not participating in event or warming up. All participants will use the ramps on the Northeast and Southeast side of the stadium for track entrance.
 - D. The first, second and third place winners must report to the awards stand immediately after their event.
 - E. Field Events: When a competitor has qualified in more than one field event:
 - a. He/She must inform the official upon check-in.
 - b. Upon leaving one event to compete in another, he/she must inform the official of time leaving and has 10 minutes to return.
 - c. Trials may be taken in succession.
 - F. The Shot and Discus weigh-in station will be in the Home Team Dressing Room. 6A boys shot put & 6A girls discus, from 7:00 am until 8:00 am. 6A boys discus and 6A girls shot put from 9:30 am until 10:30 am. 5A girls shot put and 5A boys discus from 3:00 pm until 4:00 pm. 5A boys shot put and 5A girls discus from 12:30 pm until 1:30 pm. All implements weighed in will be impounded and only certified implements will be placed in the pool for competition. All implements may be picked-up at the weigh-in station. 6A from 1:45-2:15 pm and 5A from 6:30-7:00 pm, Friday, April 28th. Athletes will be allowed to warm-up by flights prior to the start of competition with **approved** implements and under the supervision of an official.
 - G. Pole Vault weigh-in will be in the east side storage room. 6A boys weigh-in from 7:00-8:00 a.m. and 6A girls 9:30-10:30 a.m., 5A boys weigh-in from 12:30-1:30 p.m. and 5A girls 3:00 – 4:00 p.m. It is the responsibility of the coach to verify that the competitor will use a legal pole rated at or above his/her weight by submitting the **pole vault weight rating sheet** contained in this handbook at weigh- in time. Each athlete will be weighed prior to pole vault competition to make sure that pole weight and competitor weight correlates with the rules. **There will be no variance.**
 - H. No loud radios will be allowed in the stadium.
 - I. Automatic timing system and video will be used for all running events.
 - J. In running events with prelims, qualifying for the finals will be the winner of each heat and the next 6 fastest times.
 - K. FOR RUNNING EVENT PRELIMS, ATHLETES SHOULD JUDGE THEIR WARM-UP ON EVENTS, BECAUSE TIMES ARE APPROXIMATE.
 - L. Designated uniform for shot & discus participants must follow NFHS rules as specified.
 - M. Only 1/8 or 1/4 inch spikes will be allowed

- N. NO chalk, tacks, pins, powder, paint, duct tape or any items that may cause injury may be used as marks for field events and relays. ONLY white athletic tape will be allowed on the track and runways and must be removed immediately after the relay race and/or field event competition.
- O. No cell phone usage or other wireless device used for communication will be allowed on the field or during competition. However, electronic devices may be used in unrestricted areas and the designated coaches' boxes.
 - a. Electronic devices shall not be used to transmit information to the competitor during the race or trial.
 - b. Electronic devices shall not be used for any review of an official's decision.
- P. Starting heights for the Pole Vault and High Jump will be determined by the UIL Director of Athletics and the Meet Director before the meet based on District/Area entries. They will be available on the NEISD website on Tuesday, April 25th and in the coach's packet upon check-in.

III. UNIFORMS: COMPETITOR'S UNIFORM IN TRACK AND FIELD AND CROSS COUNTRY

NOTE: The wearing of medical alert with the alert visible is encouraged for risk minimization. The ultimate responsibility to have each competitor compliant with uniform rules and other reasonable and legal items is with the coach.

ART.1The competitor's uniform shall be school-issued or school-approved, worn as intended by the manufacturer, and meet the following requirements and restrictions:

- A. Each competitor shall wear shoes on both feet.
 - 1. The shoes shall have an upper and recognizable sole and heel.
 - 2. The (shoe) upper must be designed so that it can be fastened securely to the foot.

NOTE: The games committee may also determine the length of spikes allowed on all-weather surface. (3-2-4a)

- 4. The use of slippers or socks does not meet the requirements of the rule.
- B. Each competitor shall wear a school-issued or school-approved full-length track top and track bottom or one-piece uniform. Any outer garment (e.g., t-shirt, sweatpants, tights) that is school issued or school-approved becomes the official uniform, when worn.
 - 1. When numbers are used, each competitor shall wear his/her assigned, unaltered contestant number.
 - 2. The top and/or bottom or one piece uniform may have school name, school logo, school nickname and/or competitor's name.
 - 3. The top shall not be knotted or have a knot-like protrusion. Bare midriff tops are not permitted. The top must hang below or be tucked into the waistband of the uniform bottom when the competitor is standing upright.
 - 4. Loose-fitting boxer-type bottoms or compression-style bottoms are permitted for boys and girls, however, **boys must wear a loose-fitting track bottom, and they must wear shorts over the one-piece suit or compression style bottoms according to the UIL Manual.** Closed-leg briefs are acceptable for girls. French or high-cut apparel shall not be worn in lieu of the uniform bottom. The waistband of a competitor's bottom shall be worn above the hips.
 - 5. A single manufacturer's logo/trademark/reference, no more than 2 ¼ square inches with no dimension more that 2 ¼ inches, is permitted on the top and bottom or one-piece uniform.

6. One American flag, not to exceed 2 inches by 3 inches, may be worn or occupy space on each item of uniform apparel. By state association adoption, to allow for special occasions, commemorative or memorial patches, not to exceed 4 square inches, may be worn on the uniform without compromising its integrity.
7. Any visible garment(s) worn underneath the uniform top and/or bottom is considered a foundation garment. Foundation garments are not subject to logo/trademark/reference or color restrictions.

ART. 2... Additional restrictions for relay teams and cross country teams.

- A. All relay and cross country team members must wear uniforms clearly indicating, through predominant color, school logo and color combination of all outer garments worn as a uniform, that members are from the same team.

NOTE: The official should be able to observe that all members are from the same team.

PENALTY: (Articles 1, 2) For the wearing of an illegal uniform, when a violation is observed and noted by a meet official, the competitor shall be required to make the uniform legal before becoming eligible for further competition and shall be issued a warning that a subsequent violation shall result in a disqualification from the event. The referee shall be notified of the violation by the observing meet official, and the referee shall then notify or cause to be notified the head coach of the offending school of the competitor's violations and warning.

ART. 3... Removing any part of the team uniform, excluding shoes, while in the area of competition, as defined by the games committee, is illegal.

PENALTY: This shall lead to a warning and if repeated, to disqualification from the event. If the Incident recurs, the competitor will be disqualified from further competition in the meet.

IV. COACHES: *All NFHS and UIL rules will govern the events at the regional meet.*

- A. No district passes or TGCA or THSCA membership passes will be honored.
- B. A Wrist Band identifying Region IV coaches (Full-Time employee of the School District) with qualifying participants will be given out in the information packets and must be worn at all times at all sites. Do not remove the wristband if you plan on returning on Saturday. (three wristbands per team). Extra wristbands can be bought at packet pickup. \$20.00/band - Cash Only.
- C. All scratches/substitutes for events must be certified by the District/Area Track Meet Director by submitting the changes in writing to Kelly Parker @ Fax# (210) 491-6135 or by e-mail to kparke2@neisd.net *Please use the form in the Regional Meet Handbook titled Track & Field Substitute Certification Form.*
- D. **NO SUBSTITUTIONS WILL BE ACCEPTED AFTER 10:00 A.M. ON TUESDAY, APRIL 25, 2023.**
- E. Relay cards are due on Friday, April 28th at the Heroes ticket booth at the following times:

5A – 9:00 am and 6A – 2:30 pm. Names cannot be added or changed after the deadline. Relay teams will be subject to disqualification if relay cards are not turned in on time.

- F. Appeals must be made by the coach in written form and submitted to a referee at the referee station under the video board **no later than 30 minutes** after the announcement of the event results. Forms will be provided in the coaches' packet and at the referee's table.

Situations which are subject to appeal include, but are not limited to:

1. Misapplication of the rules
2. Correction of clerical or team scoring errors which must be corrected up to 48 hours after the end of the meet, unless another time period is specified in advance by the games committee or meet director.
3. Correction of meet results involving an ineligible participant which may be made at any time.
4. Failure to follow a procedure contained in the terms and conditions of competition announced in advance by the games committee or meet director. This would include such items as the time schedule, the number of qualifiers to advance, number of trials, etc.

Non-appealable situations:

1. Any judgment decision pertaining to violations or alleged violations of the rules.
2. A decision made by the finish judges or timers that does not involve misapplication of a rule or the terms and conditions of competition.
3. Whether a start is fair and legal.

NOTE: SECTION 3-4: The referee has the sole authority for ruling on infractions or irregularities not covered within the rules.

- G. No coaches will be allowed on the field of competition during running events unless summoned by the referee or filing an appeal. A field marshal will escort the coach to the referee's table.
- H. A coach's box will be provided at all field event sites for coaches, 1 coach per team with approved UIL wristband AND meet issued colored wristband and only while their athlete competes.
- I. Video equipment authorized by the meet director and games committee may be used to review appealable infractions. The replay may be viewed only by the meet referee and/or the jury of appeals
- J. Trainers Station - Trainers from the host site (NEISD) will be on duty in the Northwest (Home) locker room. The host site trainers will be allowed on the track during distance races and if they are called to administer to an athlete. Trainers may not take pictures or review videos with athletes.

V. SCORING

- A. Individual field and running events: (10-8-6-4-2-1)
B. Relays: (20-16-12-8-4-2)

VI. ADMISSION PRICES:

Students: \$5.00 one day
Adults: \$10.00 one day

- VII. All tickets will be sold online at neisd.net/Page/2881 through Ticket Spicket. Download Ticket Spicket App to purchase tickets on Google Play and Apple Store or visit <https://events.ticketspicket.com/agency/4e5ad12e-aa84-444a-990d-1d531b513645> or click on the following QR Code.



Scan Me

VIII. THERE WILL BE NO PRELIMS IN THE FOLLOWING EVENTS

- A. 5A Girls and Boys – 800, 1600 and 3200 Meter Runs
B. 6A Girls and Boys – 800, 1600 and 3200 Meter Runs

COACHES/ATHLETES MAP AND DIRECTIONS TO HEROES STADIUM (East Side)

4799 Thousand Oaks Drive-San Antonio, Texas 78233

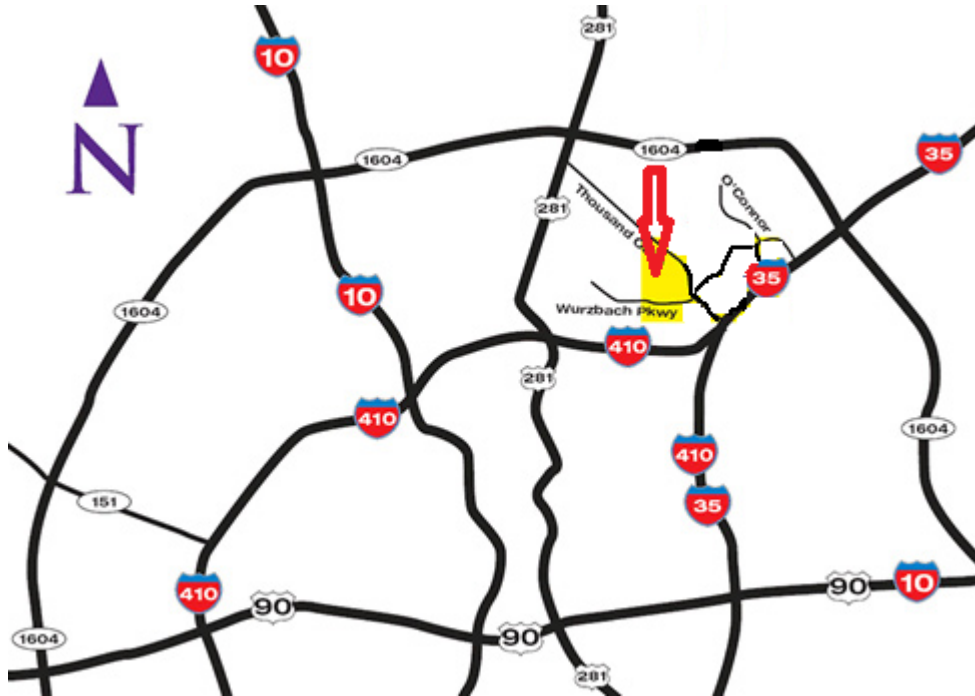

From South (Corpus Christi)

Take I-37 North. Exit 133 to merge onto I-410N to I-35N. Take Exit 167 toward Starlight Terrace/Thousand Oaks Drive. Merge onto Interstate 35 Access Road. Turn left onto Starlight Terrace/Thousand Oaks. Follow Thousand Oaks for just over half a mile and turn left onto Quarry Park to Heroes Stadium.

From West (Del Rio, Uvalde)

Take US-90 East. Exit I-10 West/I-35 North/US-87 North toward Austin/El Paso. Continue to follow I-35 North for about 14 miles. Take Exit 167 toward Starlight Terrace/Thousand Oaks Drive. Merge onto Interstate 35 Access Road. Turn Left onto Starlight Terrace/Thousand Oaks. Follow Thousand Oaks for just over half a mile and turn left onto Quarry Park to Heroes Stadium.

From East (Seguin, Houston)

Take US-90 West. Take the ramp onto I-10 West/US-90 West. Take Exit 581 and merge onto I-410. Continue onto I-35 North/North Panam Expressway. Take Exit 167 toward Starlight Terrace/Thousand Oaks Drive. Merge onto Interstate 35 Access Road.

Turn Left onto Starlight Terrace/Thousand Oaks. Follow Thousand Oaks for just over half a mile and turn left onto Quarry Park to Heroes Stadium.

From Austin or Dallas

Take I-35 South toward San Antonio. Exit 167B toward Thousand Oaks Drive/Starlight Terrace. Merge onto Interstate 35 Access Road. Turn right onto Thousand Oaks Drive. Follow Thousand Oaks for just over half a mile and turn left onto Quarry Park to Heroes Stadium.

From West (El Paso, Kerrville)

Take I-10 East to Exit 564 and merge onto I-410 East. Keep left at the fork and follow signs for I-35 North/Austin. Keep Right at the fork, follow signs for Randolph Boulevard/Windcrest. Keep Left at the fork and follow signs for I-35 North and merge onto Interstate 35 Access Road. Turn left onto Starlight Terrace/Thousand Oaks. Follow Thousand Oaks for just over half a mile and turn left onto Quarry Park to Heroes Stadium.

From Downtown San Antonio

Take I-37 N/US-281 North. Exit I-35 N/North Panam Expressway toward Austin, Exit 142A. Take exit 167 toward Starlight Terrace/Thousand Oaks Drive. Merge onto the Interstate 35 access road. Turn left onto Starlight Terrace/Thousand Oaks. Follow Thousand Oaks for just over half a mile and turn left onto Quarry Park to Heroes Stadium.

From North San Antonio (Stone Oak Area)

Take I-37 S/US-281 South. Exit onto Loop 410 E via the ramp. Keep left at the fork and continue on toward I-35 N/Austin. Keep Right at the next fork and follow signs for Randolph Boulevard/Windcrest. Keep Left at the fork and follow signs for I-35 N and merge onto the I-35 Access Road. Turn Left onto Starlight Terrace/Thousand Oaks. Follow Thousand Oaks for just over half a mile and turn left onto Quarry Park to Heroes Stadium.

From the Airport

From Airport Boulevard, turn Left onto NE 410 Loop Frontage Road. Exit onto NE Loop 410 E via the ramp on the left. Keep Left at the fork and continue on toward I-35 N/Austin. Keep Right at the next fork and follow signs for Randolph Boulevard/Windcrest. Keep Left at the fork and follow signs for I-35 N and merge onto the I-35 Access Road. Turn Left onto Starlight Terrace/Thousand Oaks. Follow Thousand Oaks for just over half a mile and turn left onto Quarry Park to Heroes Stadium.

**REGION IV 5A AND 6A
TRACK AND FIELD MEET
MAP OF STADIUM
APRIL 29-30, 2022**

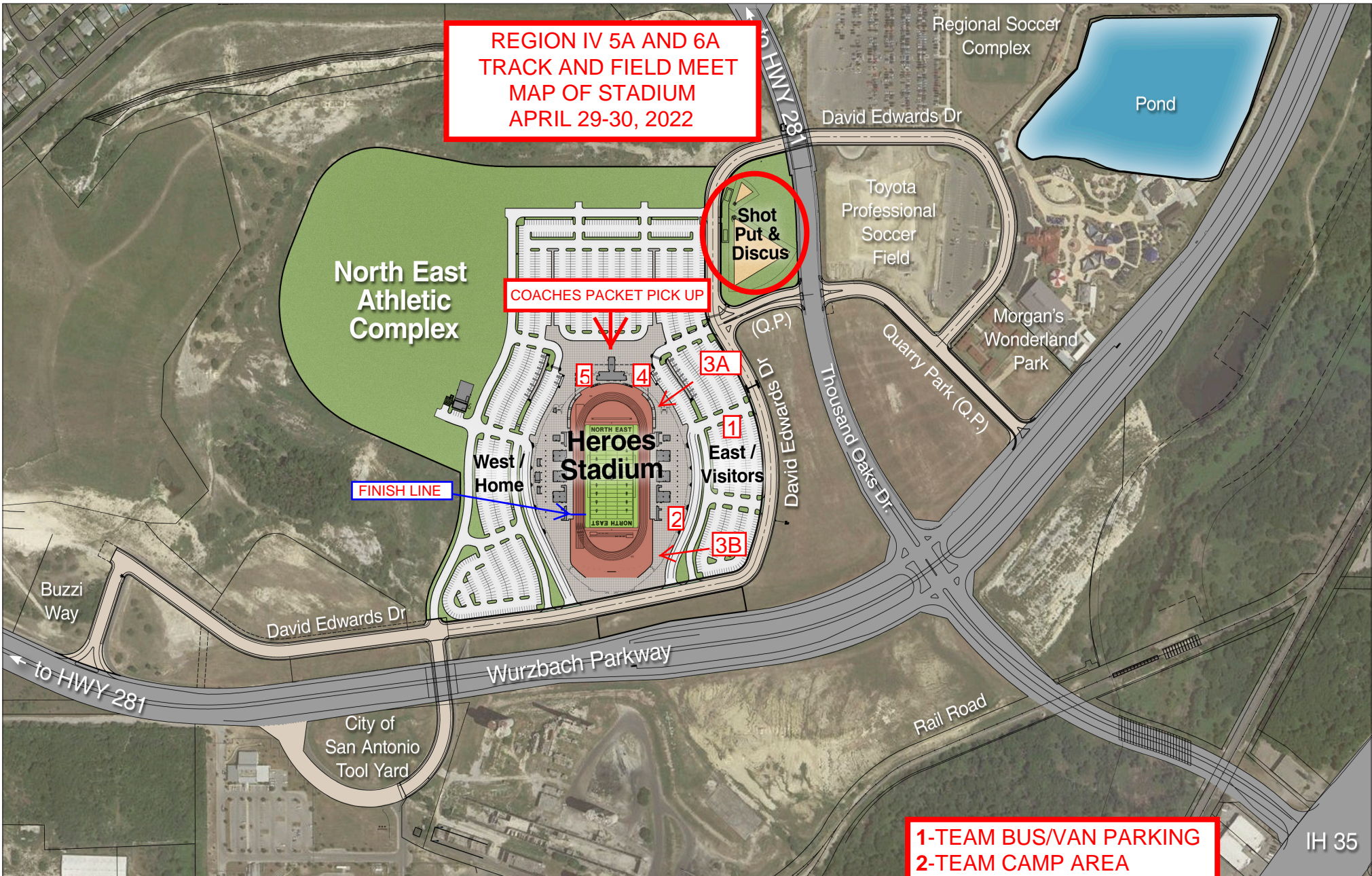

- 1-TTEAM BUS/VAN PARKING**
- 2-TTEAM CAMP AREA**
- 3A-NE TRACK ENTRANCE**
- 3B-SW TRACK ENTRANCE**
- 4-PV WEIGH IN**
(East side storage room)
- 5-SHOT/DISCUS WEIGH IN**
(West side storage room)



HEROES STADIUM
4707 David Edwards Drive
San Antonio, Texas 78233



HEROES STADIUM **TRACK MARKINGS**

GENERAL

1. The longest spike that may be used is the 1/4" pyramid.
2. No foreign materials of any kind should be placed on the track or jumping surface areas, including dusts, salt, powders, etc. If temporary markers are needed, the use of plastic or adhesive tape is acceptable, but should be removed as soon as the event is over.
3. The finish line for all events except the 100-M and 110-M Hurdles occurs at the southwest turn.
4. The curved white line at the southeast turn designates the break at the pole.

EVENT DESCRIPTIONS

- 100-M Dash** The white start line is located in the chute near the southwest turn. The white finish line is located on the west side of the track.
- 200-M Dash** The white start lines are located at the north end of the track and are staggered on turn.
- 400-M Dash** The yellow start lines are located at the south end of the track and are staggered two turns.
- 800-M Dash** The white start lines are located at the south end of the track and are staggered one turn.
- 400-M Relay** The start lines are identical to those used in the 400-M Dash. The exchange zones are typical and are colored gold.
- 800-M Relay** The blue start lines are located at the south end of the track and are staggered four turns. The exchange zones are typical and are colored blue except for the third exchange which utilizes the second exchange zone of the 400-M Relay, which is gold.
- 1600-M Relay** The green start lines are located at the south end of the track and are staggered three turns. The first exchange zone is typical and is colored green. The second and third exchanges take place between the broken green lines in each lane located at the southwest corner of the track.
- 100-M Hurdles** The start and finish lines are identical to those used in the 100-M Dash when running south to north. Hurdle settings are designated by gold triangles in each lane facing the direction of the finish line.

10 Hurdles @ 33"- High School Girls

110-M Hurdles The white start line is located in the chute near the southwest turn. The finish line is identical to that used for the 100-M Dash and the 100-M Hurdles when running from south to north.

Hurdle settings are designated by blue triangles in each lane facing the direction of the finish line.

10 Hurdles @ 39"- High School Boys

300-M Hurdles The white start lines are located near the southeast turn and are staggered one turn.

Hurdle settings are designated by green triangles in each lane.

8 Hurdles @ 30"- High School Girls

8 Hurdles @ 36"- High School Boys

NEISD HEROES STADIUM RUNWAY BOARDS

LJ & TJ PIT BOARDS

8' Yellow

12' White

20' Blue

24' Yellow

28' White

32' Blue

36' Yellow

40' Blue

TRACK & FIELD SUBSTITUTE CERTIFICATION FORM

(FOR USE BY COACH TO INFORM DISTRICT/AREA DIRECTOR OF SCRATCH)

_____ School	_____ Coach	_____ District – Conference EX: 29 – 5A
_____ Name of Athlete	_____ Event Scratched	_____ Place in District/Area

(FOR USE BY DISTRICT/AREA DIRECTOR TO INFORM REGIONAL DIRECTOR OF ADD)

District /Area Director may fax to (210) 491-6135 or email form to kparke2@neisd.net

_____ Name of Athlete Added	_____ Event	_____ Original Place in District/Area Meet
_____ School	_____ Coach	_____ District/Area Director Signature

DEADLINE FOR CHANGES: TUESDAY, APRIL 25, 2023 @ 10:00 AM

Date Submitted to Regional Director

TRACK & FIELD SUBSTITUTE CERTIFICATION FORM

(FOR USE BY COACH TO INFORM DISTRICT/AREA DIRECTOR OF SCRATCH)

_____ School	_____ Coach	_____ District – Conference EX: 29 – 5A
_____ Name of Athlete	_____ Event Scratched	_____ Place in District/Area

(FOR USE BY DISTRICT DIRECTOR/AREA TO INFORM REGIONAL DIRECTOR OF ADD)

District/Area Director may fax to (210) 491-6135 or email form to kparke2@neisd.net

_____ Name of Athlete Added	_____ Event	_____ Original Place in District/Area Meet
_____ School	_____ Coach	_____ District/Area Director Signature

DEADLINE FOR CHANGES: TUESDAY, APRIL 25, 2023 @ 10:00 A.M.

Date Submitted to Regional Director

Practice Relay Cards

These will not be accepted as official relay cards.

OFFICIAL RELAY CARDS WILL BE AVAILABLE AT CHECK IN

4x100 (400 METER RELAY)

	PRINT FIRST AND LAST NAMES NEATLY	PRELIMS	FINALS
1.			
2.			
3.			
4.			
5. alt			
6. alt			

4X200 (800 METER RELAY)

	PRINT FIRST AND LAST NAMES NEATLY	PRELIMS	FINALS
1.			
2.			
3.			
4.			
5. alt			
6. alt			

4X400 (1600 METER RELAY)

	PRINT FIRST AND LAST NAMES NEATLY	PRELIMS	FINALS
1.			
2.			
3.			
4.			
5. alt			
6. alt			



UIL Pole Vault Certification Form

In compliance with the National Federation of High Schools Track and Field Rule 7-5-3, this form is provided to verify pole vaulter's weights and pole ratings prior to warm-up and competition.

Vaulter's School:	Coach's Name (print):
Site of Competition:	Date of Competition:

Vaulter's Name:	Vaulter's Weight:	lbs.
Pole #1: Length:	Pole Rating Weight:	lbs.
Pole #2: Length:	Pole Rating Weight:	lbs.
Pole #3: Length:	Pole Rating Weight:	lbs.
Pole #4: Length:	Pole Rating Weight:	lbs.
Pole #5: Length:	Pole Rating Weight:	lbs.
Pole #6: Length:	Pole Rating Weight:	lbs.
Pole #7: Length:	Pole Rating Weight:	lbs.
Pole #8: Length:	Pole Rating Weight:	lbs.
Athlete Signature:	Date:	

Coach's Printed Name:	Date:
Coach's Signature:	Date:



UIL Pole Vault Certification Form

In compliance with the National Federation of High Schools Track and Field Rule 7-5-3, this form is provided to verify pole vaulter's weights and pole ratings prior to warm-up and competition.

Vaulter's School:	Coach's Name (print):
Site of Competition:	Date of Competition:

Vaulter's Name:	Vaulter's Weight:	lbs.
Pole #1: Length:	Pole Rating Weight:	lbs.
Pole #2: Length:	Pole Rating Weight:	lbs.
Pole #3: Length:	Pole Rating Weight:	lbs.
Pole #4: Length:	Pole Rating Weight:	lbs.
Pole #5: Length:	Pole Rating Weight:	lbs.
Pole #6: Length:	Pole Rating Weight:	lbs.
Pole #7: Length:	Pole Rating Weight:	lbs.
Pole #8: Length:	Pole Rating Weight:	lbs.
Athlete Signature:	Date:	

Coach's Printed Name:	Date:
Coach's Signature:	Date:

The following are NFHS Track and Field Rules relevant to pole vault safety:

Rule 7-5-2: The vaulting pole may be of any material and of length and diameter. It may have a binding of not more than two layers of adhesive tape of uniform thickness. However, the bottom of the pole may be protected by several layers of tape, PVC, metal, sponge rubber, or other suitable material to protect it when placed in the planting box.

Rule 7-5-3: The competitor's weight shall be at or below the manufacturer's pole rating. The manufacturers must include on each pole: the pole rating that shall be a minimum of $\frac{3}{4}$ inch in a contrasting color located within or above the top hand-hold position; a 1-inch circular band indicating the maximum top hand-hold position with the position being determined by the manufacturer. Prior to the competition, the Coach must verify that all of the schools' pole vaulters meet these requirements.

7-5-4: A competitor shall not use a variable weight pole, a pole which is improperly marked, or a pole rated below his/her weight, or any other equipment that is not legal during warm-up or competition. **NOTE:** Altering the pole in any fashion renders it illegal. **PENALTY: Disqualification from the event.**

7-5-5: Prior to warm-up, the field referee, head field judge, or assigned inspector of implements shall inspect each pole to be used in the competition to verify that the poles are legal equipment, per Rule 7-5-3. This includes checking the placement of a top hand-hold band, numerical pole ratings a minimum of $\frac{3}{4}$ -inches in a contrasting color located within or above the top hand-hold band, and the proper binding of not more than two layers of adhesive tape of uniform thickness. The binding shall not be on or above the top handhold band.

7-5-23: A competitor shall not be allowed to use the pole of another individual without the consent of the owner. The event judge shall approve the use and verify that the pole is rated weight-appropriate. **PENALTY: Disqualification from the event.**

Rule 7-5-29h: It is a foul if the competitor grips the pole above the top handhold band. **PENALTY: An unsuccessful trial is charged, but not measured.**

The following are NFHS Track and Field Rules relevant to pole vault safety:

Rule 7-5-2: The vaulting pole may be of any material and of length and diameter. It may have a binding of not more than two layers of adhesive tape of uniform thickness. However, the bottom of the pole may be protected by several layers of tape, PVC, metal, sponge rubber, or other suitable material to protect it when placed in the planting box.

Rule 7-5-3: The competitor's weight shall be at or below the manufacturer's pole rating. The manufacturers must include on each pole: the pole rating that shall be a minimum of $\frac{3}{4}$ inch in a contrasting color located within or above the top hand-hold position; a 1-inch circular band indicating the maximum top hand-hold position with the position being determined by the manufacturer. Prior to the competition, the Coach must verify that all of the schools' pole vaulters meet these requirements.

7-5-4: A competitor shall not use a variable weight pole, a pole which is improperly marked, or a pole rated below his/her weight, or any other equipment that is not legal during warm-up or competition. **NOTE:** Altering the pole in any fashion renders it illegal. **PENALTY: Disqualification from the event.**

7-5-5: Prior to warm-up, the field referee, head field judge, or assigned inspector of implements shall inspect each pole to be used in the competition to verify that the poles are legal equipment, per Rule 7-5-3. This includes checking the placement of a top hand-hold band, numerical pole ratings a minimum of $\frac{3}{4}$ -inches in a contrasting color located within or above the top hand-hold band, and the proper binding of not more than two layers of adhesive tape of uniform thickness. The binding shall not be on or above the top handhold band.

7-5-23: A competitor shall not be allowed to use the pole of another individual without the consent of the owner. The event judge shall approve the use and verify that the pole is rated weight-appropriate. **PENALTY: Disqualification from the event.**

Rule 7-5-29h: It is a foul if the competitor grips the pole above the top handhold band. **PENALTY: An unsuccessful trial is charged, but not measured.**

TIME: _____

OFFICE OF ATHLETICS

APPEAL FORM

TIME OF EVENT: _____ A.M. P.M. TIME OF FILING: _____ A.M. P.M.

Describe in detail the reason for this appeal: _____



Identify your approximate position at the time of the violation with "X".
Identify the location of the violation with "V". Identify other witness with "W".

Names of Witnesses: _____

Please identify what rule was specifically violated:
Rule# _____, Section _____ Article _____

SIGNATURE OF HEAD COACH

HyTek Procedures for District/Area Track Meet Director 2022:

If you use HyTek, *immediately after your meet*, export the advancers, and email them to the HyTeK Official at thasti@neisd.net

You will also need to fax your meet results with finishers of places 1 – 8.

The fax number is (210) 491-6135

If problems occur please call 210-356-6923

Data Entry Checklist:

1. Please check that all athlete names are spelled correctly with correct capitalization (ex. John Doe is correct...not john doe or JOHN DOE.)
2. The “year in school” should be included for each athlete in the following format: 09 for 9th grade, 10 for 10th grade, 11 for 11th grade and 12 for 12th grade.
3. Input names of the relay team members under each relay, including the relay alternates (maximum of 8 names).
4. Field event results must resolve all ties through 6th place using NFHS tiebreaker rules.

Creating the District Meet Using HyTek Windows Meet Manager:

1. Divisions: Under “Meet Setup” choose “Divisions by Event.” Also, click Set-up: “Division/Region Names” and choose “Divisions.” Use your conference as listed in the chart below. This set up will put your conference in the correct events when imported.

This is a very important step.

Div#	Code	Division Name
5	5A	5A
6	6A	6A

2. Event Numbers: *The attached event numbers must be used to ensure that we can merge your meet with ours.* Be sure and use your conference event numbers. Be sure the person in charge of computer scoring gets these event numbers.

6A Codes

601 – Women 3200 Meter Run 4A
602 – Men 3200 Meter Run 4A
603 – Women 4x100 Meter Relay 4A
604 – Men 4X100 Meter Relay 4A
605 – Women 800 Meter Run 4A
606 – Men 800 Meter Run 4A
607 – Women 100 Meter Hurdles 4A
608 – Men 110 Meter Hurdles 4A
609 – Women 100 Meter Dash 4A
610 – Men 100 Meter Dash 4A
611 – Women 4x200 Meter Relay 4A
612 – Men 4x200 Meter Relay 4A
613 – Women 400 Meter Dash 4A
614 – Men 400 Meter Dash 4A
615 – Women 300 Meter Hurdles 4A
616 – Men 300 Meter Hurdles 4A

5A Codes

501 – Women 3200 Meter Run 5A
502 – Men 3200 Meter Run 5A
503 – Women 4x100 Meter Relay 5A
504 – Men 4X100 Meter Relay 5A
505 – Women 800 Meter Run 5A
506 – Men 800 Meter Run 5A
507 – Women 100 Meter Hurdles 5A
508 – Men 110 Meter Hurdles 5A
509 – Women 100 Meter Dash 5A
510 – Men 100 Meter Dash 5A
511 – Women 4x200 Meter Relay 5A
512 – Men 4x200 Meter Relay 5A
513 – Women 400 Meter Dash 5A
514 – Men 400 Meter Dash 5A
515 – Women 300 Meter Hurdles 5A
516 – Men 300 Meter Hurdles 5A

617 – Women 200 Meter Dash 4A	517 – Women 200 Meter Dash 5A
618 - Men 200 Meter Dash 4A	518 – Men 200 Meter Dash 5A
619 – Women 1600 Meter Run 4A	519 – Women 1600 Meter Run 5A
620 – Men 1600 Meter Run 4A	520 – Men 1600 Meter Run 5A
621 – Women 4x400 Meter Relay 4A	521 – Women 4x400 Meter Relay 5A
622 – Men 4x400 Meter Relay 4A	522 – Men 4X400 Meter Relay 5A
623 – Women Discus Throw 4A	523 – Women Discus Throw 5A
624 – Men Discus Throw 4A	524 – Men Discus Throw 5A
625 – Women High Jump 4A	525 – Women High Jump 5A
626 – Men High Jump 4A	526 – Men High Jump 5A
627 – Women Long Jump 4A	527 – Women Long Jump 5A
628 – Men Long Jump 4A	528 – Men Long Jump 5A
629 – Women Pole Vault 4A	529 – Women Pole Vault 5A
630 – Men Pole Vault 4A	530 – Men Pole Vault 4A
631 – Women Shot Put 4A	531 – Women Shot Put 4A
632 – Men Shot Put 4A	532 – Men Shot Put 5A
633 – Women Triple Jump 4A	533 – Women Triple Jump 5A
634 – Men Triple Jump 4A	534 – Men Triple Jump 5A

3. School Codes: The UIL school codes must be used for the HyTek program to work properly. The school code and the school code name must be the same as listed on the UIL list. DO NOT put HS or High School after the school names.

The HyTek program does not identify the school unless both of these items are typed correctly.

Be sure the person in charge of computer scoring gets these school codes. The schools and codes can be found on the UIL Website on this link:

<http://www.uil texas.org/track-field/school-codes>

Instructions for Exporting Advancers from HyTek Windows Meet Manager to the Regional Meet Director:

Advancers: Follow the steps below to export advancers to Regional Meet.

1. Under “File” choose “Export” then choose “Advancers”.
2. Under Advancers you will select all events.

From District to Regionals:

Top How Many From Each Event Advance: 2

From Area to Regionals :

Top How Many From Each Event Advance: 4

Maximum Qualifiers per Event: Leave Blank

Include Relay Names Check this (we NEED relay names)

Custom Select Advancers Leave Blank

3. Then create the export.
4. Email this report to Regional Meet Manager at: thasti@neisd.net
5. Fax the results to Regional Meet Manager at 210-491-6135 immediately after the meet. The results **DO NOT** need to be typed on the UIL Track And Field District Result Form. You may use the HyTek results format.

2022-23 5A/6A Track & Field School Names & School Codes

School Name	School Code	Conference	District	Region
El Paso Andress	EPAN	5A	1	1
El Paso Burges	EPBU	5A	1	1
Canutillo	CANU	5A	1	1
El Paso	ELPA	5A	1	1
El Paso Jefferson	EPJE	5A	1	1
El Paso Chapin	EPCH	5A	1	1
El Paso Bel Air	EPBA	5A	2	1
El Paso Del Valle	EPDV	5A	2	1
El Paso Hanks	EPHA	5A	2	1
El Paso Parkland	EPPA	5A	2	1
El Paso Ysleta	EPYS	5A	2	1
Clint Horizon	CLHO	5A	2	1
Amarillo	AMAR	5A	3	1
Amarillo Caprock	AMCA	5A	3	1
Amarillo Palo Duro	AMPD	5A	3	1
Plainview	PLAV	5A	3	1
Amarillo Tascosa	AMTA	5A	3	1
Abilene	ABIL	5A	4	1
Abilene Cooper	ABCO	5A	4	1
Lubbock Cooper	LUCO	5A	4	1
Lubbock Coronado	LUCR	5A	4	1
Lubbock	LUBB	5A	4	1
Lubbock Monterey	LUMO	5A	4	1
Abilene Wylie	ABWY	5A	4	1
Aledo	ALED	5A	5	1
Azle	AZLE	5A	5	1
White Settlement Brewer	WSBR	5A	5	1

Granbury	GRAN	5A	5	1
Northwest	NOWE	5A	5	1
Wichita Falls Rider	WFRI	5A	5	1
Saginaw	SAGI	5A	5	1
Ft Worth Arlington Hts	FWAH	5A	6	1
Everman	EVER	5A	6	1
Ft Worth North Side	FWNS	5A	6	1
Ft Worth Polytechnic	FWPO	5A	6	1
Ft Worth Southwest	FWSW	5A	6	1
Ft Worth Trimble Tech	FWTT	5A	6	1
Ft Worth Wyatt	FWWY	5A	6	1
Ft Worth South Hills	FWSH	5A	6	1
Colleyville Heritage	COHE	5A	7	1
Denton	DENT	5A	7	1
Grapevine	GRPV	5A	7	1
Lake Dallas	LADA	5A	7	1
N Richland Hills Richland	NRHR	5A	7	1
Denton Ryan	DERY	5A	7	1
Argyle	ARGY	5A	7	1
N Richland Hills Birdville	NRHB	5A	7	1
Burleson	BURL	5A	8	1
Cleburne	CLEB	5A	8	1
Joshua	JOSH	5A	8	1
Midlothian	MILO	5A	8	1
Mansfield Summit	MASU	5A	8	1
Arlington Seguin	ARSE	5A	8	1
Mansfield Timberview	MATI	5A	8	1
Burleson Centennial	BCEN	5A	8	1
Midlothian Heritage	MIHE	5A	8	1
Frisco	FRIS	5A	9	2
Carrollton Smith	CASM	5A	9	2
Lewisville The Colony	LETC	5A	9	2
Carrollton Turner	CATU	5A	9	2
Carrollton Creekview	CACR	5A	9	2
Frisco Wakeland	FRWA	5A	9	2
Frisco Lone Star	FRLO	5A	9	2
Frisco Reedy	FRRE	5A	9	2
Frisco Centennial	FRCE	5A	10	2
Frisco Liberty	FRLI	5A	10	2
Frisco Heritage	FRHE	5A	10	2
Frisco Independence	FRIN	5A	10	2
Frisco Lebanon Trail	FRLE	5A	10	2
Frisco Memorial	FRME	5A	10	2
Frisco Emerson	FREM	5A	10	2
Dallas Adamson	DAAM	5A	11	2
Dallas Hillcrest	DAHI	5A	11	2
Dallas Jefferson	DAJE	5A	11	2
Dallas Kimball	DAKI	5A	11	2

Dallas South Oak Cliff	DASO	5A	11	2
Dallas Sunset	DASU	5A	11	2
Dallas White	DAWH	5A	11	2
Dallas Wilson	DAWI	5A	11	2
Dallas Molina	DAMO	5A	11	2
Dallas Adams	DAAD	5A	12	2
North Mesquite	MENM	5A	12	2
Mesquite Poteet	MEPO	5A	12	2
Dallas Samuell	DASA	5A	12	2
Dallas Seagoville	DASE	5A	12	2
Dallas Spruce	DASP	5A	12	2
West Mesquite	MEWM	5A	12	2
Dallas Conrad	DACO	5A	12	2
Denison	DENI	5A	13	2
Greenville	GREN	5A	13	2
Princeton	PRIN	5A	13	2
Sherman	SHER	5A	13	2
McKinney North	MCNO	5A	13	2
Melissa	MELI	5A	13	2
Lucas Lovejoy	LULO	5A	13	2
Corsicana	CORS	5A	14	2
Crandall	CRAN	5A	14	2
Ennis	ENNI	5A	14	2
Forney	FORN	5A	14	2
Lancaster	LANC	5A	14	2
Red Oak	REDO	5A	14	2
Terrell	TERR	5A	14	2
Hallsville	HALS	5A	15	2
Longview	LONG	5A	15	2
Marshall	MARS	5A	15	2
Mount Pleasant	MOPL	5A	15	2
Longview Pine Tree	LOPT	5A	15	2
Texarkana Texas	TXTX	5A	15	2
Tyler	TYLR	5A	15	2
Whitehouse	WHHO	5A	15	2
Dayton	DAYT	5A	16	2
Huntsville	HUSV	5A	16	2
Lufkin	LUFK	5A	16	2
Nacogdoches	NACO	5A	16	2
Humble Kingwood Park	HKPA	5A	16	2
New Caney Porter	NCPO	5A	16	2
Mt Belvieu Barbers Hill	MBBH	5A	17	3
Crosby	CROS	5A	17	3
Baytown Lee	BALE	5A	17	3
Port Neches-Groves	PONG	5A	17	3
Baytown Sterling	BYST	5A	17	3
Nederland	NEDR	5A	17	3
Port Arthur Memorial	PAME	5A	17	3

Baytown Goose Crk Mem	BAGC	5A	17	3
Angleton	ANGL	5A	18	3
Galveston Ball	GALB	5A	18	3
Friendswood	FRSW	5A	18	3
La Porte	LAPO	5A	18	3
Santa Fe	SAFE	5A	18	3
Texas City	TXCI	5A	18	3
Manvel	MANV	5A	18	3
H Austin	HOAU	5A	19	3
H Northside	HONS	5A	19	3
Galena Park	GALP	5A	19	3
H Wisdom	HOWI	5A	19	3
H Madison	HOMD	5A	19	3
H Milby	HOMI	5A	19	3
H Sharpstown	HOSH	5A	19	3
H Sterling	HOST	5A	19	3
H Waltrip	HWAL	5A	19	3
H Carnegie Vanguard	HOCV	5A	19	3
Fort Bend Kempner	FBKE	5A	20	3
Rosenberg Lamar Cons	ROLC	5A	20	3
Rosenberg Terry	ROTE	5A	20	3
Fort Bend Willowridge	FBWI	5A	20	3
Richmond Foster	RIFO	5A	20	3
Fort Bend Marshall	FBMA	5A	20	3
Lamar Fulshear	LFUL	5A	20	3
Richmond Randle	RIRA	5A	20	3
Brenham	BREN	5A	21	3
Magnolia	MAGN	5A	21	3
Montgomery	MONT	5A	21	3
Magnolia West	MAWE	5A	21	3
Bryan Rudder	BRRU	5A	21	3
College Station	CSTH	5A	21	3
College Station A&M Consolidated	CSAM	5A	21	3
Montgomery Lake Creek	MOLC	5A	21	3
Belton	BELT	5A	22	3
Killeen Ellison	KIEL	5A	22	3
Killeen	KILE	5A	22	3
Waco University	WAUN	5A	22	3
Waco	WACO	5A	22	3
Killeen Shoemaker	KISH	5A	22	3
Lake Belton	LBEL	5A	22	3
Killeen Chaparral	KICH	5A	22	3
Bastrop	BAST	5A	23	3
Pflugerville Connally	PFCO	5A	23	3
Elgin	ELGI	5A	23	3
Georgetown	GEGT	5A	23	3
Pflugerville	PFLU	5A	23	3
Pflugerville Hendrickson	PFHE	5A	23	3

Bastrop Cedar Creek	BACC	5A	23	3
Georgetown East View	GEEV	5A	23	3
Austin Crockett	AUCR	5A	24	3
Austin Johnson	AUJO	5A	24	3
Austin Eastside	AUEM	5A	24	3
Austin Navarro	AUNA	5A	24	3
Austin McCallum	AUMC	5A	24	3
Austin Northeast	AUNE	5A	24	3
Austin Travis	AUTR	5A	24	3
Austin Ann Richards	AUAR	5A	24	3
Austin LASA	AULA	5A	24	3
Buda Hays	BUDA	5A	25	4
Leander	LEAN	5A	25	4
Liberty Hil	LIHI	5A	25	4
Lockhart	LOCK	5A	25	4
Cedar Park	CEPA	5A	25	4
Kyle Lehman	KYLE	5A	25	4
Leander Rouse	LROU	5A	25	4
Leander Glenn	LEGL	5A	25	4
Comal Canyon	NEBC	5A	26	4
Comal Smithson Valley	SBSV	5A	26	4
Kerrville Tivy	KERR	5A	26	4
San Antonio Wagner	SAWG	5A	26	4
Seguin	SEGU	5A	26	4
Boerne Champion	BOCH	5A	26	4
SA Veterans Memorial	JUVM	5A	26	4
Comal Pieper	COPI	5A	26	4
SA Alamo Heights	SAAH	5A	27	4
SA Brackenridge	SABR	5A	27	4
San Antonio Burbank	SABU	5A	27	4
San Antonio Edison	SAED	5A	27	4
San Antonio Highlands	SAHI	5A	27	4
San Antonio Houston	SAHO	5A	27	4
San Antonio Jefferson	SAJE	5A	27	4
San Antonio Lanier	SALA	5A	27	4
San Antonio MacArthur	SAMR	5A	27	4
Eagle Pass Winn	EPWI	5A	28	4
San Antonio Harlandale	SAHA	5A	28	4
San Antonio McCollum	SAMC	5A	28	4
Castroville Medina Valley	CAMV	5A	28	4
South San Antonio	SOSA	5A	28	4
San Antonio Southside	SASS	5A	28	4
San Antonio Southwest	SASW	5A	28	4
Southwest Legacy	SASL	5A	28	4
SA SW CAST STEM HS	SASC	5A	28	4
CC Carroll	CCCR	5A	29	4
CC Flour Bluff	CCFB	5A	29	4
Gregory-Portland	GREG	5A	29	4

Corpus Christi King	CCKI	5A	29	4
Corpus Christi Miller	CCMI	5A	29	4
Corpus Christi Moody	CCMO	5A	29	4
Corpus Christi Ray	CCRA	5A	29	4
Victoria East	VICE	5A	29	4
Victoria West	VICW	5A	29	4
CC Veterans Memorial	CCVM	5A	29	4
Laredo Cigarroa	LACI	5A	30	4
Laredo Martin	LARM	5A	30	4
Laredo Nixon	LANI	5A	30	4
Rio Grande City	RGCI	5A	30	4
Roma	ROMA	5A	30	4
Mission Veterans Memorial	MVEM	5A	30	4
La Joya Juarez-Lincoln	LJLJ	5A	30	4
La Joya Palmview	LJPA	5A	30	4
McAllen	MCAL	5A	31	4
McAllen Memorial	MCME	5A	31	4
PSJA Memorial	PJAM	5A	31	4
PSJA North	PJAN	5A	31	4
McAllen Rowe	MCRO	5A	31	4
Mission Sharyland	MISH	5A	31	4
Pharr Valley View	PHVV	5A	31	4
PSJA Southwest	PJAS	5A	31	4
Edinburg Vela	EDVL	5A	31	4
Sharyland Pioneer	MSHP	5A	31	4
Donna	DONN	5A	32	4
Edcouch-Elsa	EDEL	5A	32	4
Harlingen South	HASO	5A	32	4
Brownsville Lopez	BRLO	5A	32	4
Mercedes	MERC	5A	32	4
Brownsville Pace	BRPA	5A	32	4
Brownsville Porter	BRPO	5A	32	4
Weslaco East	WEEA	5A	32	4
Brownsville Veterans Memorial	BRVE	5A	32	4
Donna North	DONO	5A	32	4
El Paso Americas	EPAM	6A	1	1
El Paso Coronado	EPCO	6A	1	1
El Paso Eastwood	EPEA	6A	1	1
El Paso Franklin	EPFR	6A	1	1
El Paso Montwood	EPMO	6A	1	1
El Paso Socorro	EPSO	6A	1	1
El Paso El Dorado	EPED	6A	1	1
El Paso Eastlake	EPEL	6A	1	1
El Paso Pebble Hills	EPPH	6A	1	1
San Angelo Central	SACE	6A	2	1
Wolfforth Frenship	WOFR	6A	2	1
Midland Legacy	MILE	6A	2	1

Midland	MIDL	6A	2	1
Odessa	ODES	6A	2	1
Odessa Permian	ODPE	6A	2	1
Hurst Bell	HUBE	6A	3	1
Ft Worth Boswell	FWBO	6A	3	1
Crowley	CRLY	6A	3	1
Ft Worth Paschal	FWPA	6A	3	1
Eules Trinity	EUTR	6A	3	1
Weatherford	WEAT	6A	3	1
North Crowley	NCRO	6A	3	1
FW Chisholm Trail	FWCT	6A	3	1
Southlake Carroll	SOCA	6A	4	1
Keller Fossil Ridge	KEFR	6A	4	1
Haltom City Haltom	HACI	6A	4	1
Keller	KELL	6A	4	1
Keller Central	KECE	6A	4	1
Northwest Nelson	NONE	6A	4	1
Keller Timber Creek	KETC	6A	4	1
Northwest Eaton	NWEA	6A	4	1
Allen	ALLE	6A	5	1
Little Elm	LIEL	6A	5	1
McKinney	MCKI	6A	5	1
Prosper	PROS	6A	5	1
Denton Guyer	DEGU	6A	5	1
McKinney Boyd	MCBO	6A	5	1
Denton Braswell	DEBR	6A	5	1
Prosper Rock Hill	PRHI	6A	5	1
Coppell	COPP	6A	6	1
Lewisville	LEWI	6A	6	1
Lewisville Marcus	LEMA	6A	6	1
Plano East	PLPE	6A	6	1
Plano	PLAN	6A	6	1
Lewisville Hebron	LEHE	6A	6	1
Lewisville Flower Mound	LEFM	6A	6	1
Plano West	PLWE	6A	6	1
Richardson Berkner	RIBE	6A	7	1
Dallas Highland Park	DAHP	6A	7	1
Irving	IRVI	6A	7	1
Richardson Lake Highlands	RILH	6A	7	1
Irving MacArthur	IRMA	6A	7	1
Irving Nimitz	IRNI	6A	7	1
Richardson Pearce	RIPE	6A	7	1
Richardson	RICH	6A	7	1
Dallas Jesuit	DJES	6A	7	1
Arlington	ARLI	6A	8	1
Arlington Bowie	ARBO	6A	8	1
Grand Prairie	GRPR	6A	8	1
Arlington Houston	ARHO	6A	8	1

Arlington Lamar	ARLA	6A	8	1
Arlington Martin	ARMA	6A	8	1
South Grand Prairie	GPSG	6A	8	1
Garland	GARL	6A	9	2
Garland Lakeview Cent	GALC	6A	9	2
Garland Naaman Forest	GANF	6A	9	2
North Garland	GANG	6A	9	2
Garland Rowlett	GARO	6A	9	2
South Garland	GASG	6A	9	2
Wylie	WYLE	6A	9	2
Garland Sachse	GASA	6A	9	2
Wylie East	WYEA	6A	9	2
Tyler Legacy	TYLE	6A	10	2
Mesquite	MESQ	6A	10	2
Rockwall	RKWL	6A	10	2
Royse City	ROCI	6A	10	2
Mesquite Horn	MEHN	6A	10	2
Rockwall Heath	ROHE	6A	10	2
North Forney	NOFO	6A	10	2
Cedar Hill	CEHI	6A	11	2
De Soto	DESO	6A	11	2
Duncanville	DUNC	6A	11	2
Mansfield	MANS	6A	11	2
Dallas Skyline	DASK	6A	11	2
Waxahachie	WAXA	6A	11	2
Mansfield Legacy	MALE	6A	11	2
Mansfield Lake Ridge	MNLR	6A	11	2
Bryan	BRYA	6A	12	2
Copperas Cove	COCO	6A	12	2
Hutto	HUTT	6A	12	2
Waco Midway	WAMI	6A	12	2
Temple	TEMP	6A	12	2
Killeen Harker Heights	KIHH	6A	12	2
Pflugerville Weiss	PFWE	6A	12	2
Conroe Caney Creek	COCC	6A	13	2
Cleveland	CLEV	6A	13	2
Conroe	CONR	6A	13	2
New Caney	NECA	6A	13	2
Conroe Oak Ridge	COOR	6A	13	2
Conroe The Woodlands	COTW	6A	13	2
Willis	WILL	6A	13	2
Conroe Woodlands College Park	CWCP	6A	13	2
Conroe Grand Oaks	COGO	6A	13	2
Houston Aldine	HOAL	6A	14	2
Houston Eisenhower	HOEI	6A	14	2
Houston MacArthur	HOMA	6A	14	2
Houston Nimitz	HONI	6A	14	2
Spring	SPRI	6A	14	2

Spring Westfield	SPWF	6A	14	2
Spring Dekaney	SPDE	6A	14	2
Houston Benjamin Davis Sr	HOBD	6A	14	2
Klein Forest	KLFO	6A	15	2
Klein	KLEI	6A	15	2
Klein Oak	KLOA	6A	15	2
Tomball	TOMB	6A	15	2
Waller	WALE	6A	15	2
Klein Collins	KLCO	6A	15	2
Tomball Memorial	TOMM	6A	15	2
Klein Cain	KLCA	6A	15	2
Cyp. Falls	HOFL	6A	16	2
Langham Creek	HOLC	6A	16	2
Cyp. Springs	HOCS	6A	16	2
Cyp. Woods	HOCW	6A	16	2
Cyp. Ranch	HORA	6A	16	2
Cyp. Lakes	HOLK	6A	16	2
Cyp. Park	HOCP	6A	16	2
Bridgeland	BRID	6A	16	2
Cyp. Creek	HOCC	6A	17	3
Cy-Fair	HOCF	6A	17	3
Jersey Village	HOJV	6A	17	3
Houston Memorial	HOME	6A	17	3
Houston Northbrook	HONB	6A	17	3
Houston Spring Woods	HOSW	6A	17	3
Houston Stratford	HSTR	6A	17	3
Cyp. Ridge	HOCR	6A	17	3
H Bellaire	HOBE	6A	18	3
H Math Sci. & Tech	HOMS	6A	18	3
H Lamar	HOLA	6A	18	3
H Heights	HOHE	6A	18	3
H Westbury	HOWB	6A	18	3
H Chavez	HOCH	6A	18	3
H Westside	HOWS	6A	18	3
Katy	KATY	6A	19	3
Katy Mayde Creek	KAMC	6A	19	3
Katy Taylor	KATA	6A	19	3
Katy Cinco Ranch	KACR	6A	19	3
Katy Morton Ranch	KAMR	6A	19	3
Katy Seven Lakes	KASL	6A	19	3
Katy Tompkins	KTOM	6A	19	3
Katy Paetow	KAPA	6A	19	3
Katy Jordan	KJOR	6A	19	3
Fort Bend Austin	FBAU	6A	20	3
Fort Bend Clements	FBCL	6A	20	3
Fort Bend Dulles	FBDU	6A	20	3
Fort Bend Elkins	FBEL	6A	20	3
Fort Bend Hightower	FBHI	6A	20	3

Fort Bend Bush	FBBU	6A	20	3
Fort Bend Travis	FBTR	6A	20	3
Richmond George Ranch	RIGR	6A	20	3
Fort Bend Ridge Point	FBRP	6A	20	3
Humble	HUMB	6A	21	3
Sheldon King	HOKI	6A	21	3
Humble Kingwood	HUKI	6A	21	3
Galena Park North Shore	GPNS	6A	21	3
Beaumont West Brook	BEWB	6A	21	3
Humble Atascocita	HUAT	6A	21	3
Humble Summer Creek	HUSC	6A	21	3
Beaumont United	BEUN	6A	21	3
Channelview	CHAV	6A	22	3
Deer Park	DEER	6A	22	3
Pasadena Dobie	PADO	6A	22	3
Pasadena	PASA	6A	22	3
Pasadena Rayburn	PARA	6A	22	3
Pasadena South Houston	PASH	6A	22	3
Pasadena Memorial	PASM	6A	22	3
Alvin	ALVI	6A	23	3
Alief Hastings	ALHA	6A	23	3
Pearland	PEAR	6A	23	3
Alief Elsik	ALEL	6A	23	3
Alief Taylor	ALTA	6A	23	3
Houston Strake Jesuit	HSJE	6A	23	3
Pearland Dawson	PEDA	6A	23	3
Alvin Shadow Creek	ALSC	6A	23	3
Clute Brazoswood	CLBW	6A	24	3
Frndswd Clear Brook	FRCB	6A	24	3
LC Clear Creek	LCCC	6A	24	3
Houston Clear Lake	HOCL	6A	24	3
Dickinson	DICK	6A	24	3
LC Clear Springs	LCCS	6A	24	3
LC Clear Falls	LCCF	6A	24	3
Manor	MANO	6A	25	4
Round Rock McNeil	RRMC	6A	25	4
Round Rock	RORO	6A	25	4
Round Rock Westwood	RRWE	6A	25	4
Round Rock Stony Pt.	RRSP	6A	25	4
Cedar Park Vista Ridge	CPVR	6A	25	4
Austin Vandegrift	AUVA	6A	25	4
RR Cedar Ridge	RRCR	6A	25	4
Austin Anderson	AUAN	6A	26	4
Austin	AUST	6A	26	4
Austin Bowie	AUBO	6A	26	4
Del Valle	DEVA	6A	26	4
Dripping Springs	DRIP	6A	26	4
Austin Lake Travis	AULT	6A	26	4

Austin Akins	AUAK	6A	26	4
Austin Westlake	AUWL	6A	26	4
Buda Johnson	BUJO	6A	26	4
Schertz Clemens	SCCL	6A	27	4
San Antonio E. Central	SAEC	6A	27	4
Converse Judson	COJU	6A	27	4
New Braunfels	NEBR	6A	27	4
San Marcos	SANM	6A	27	4
Cibolo Steele	CIST	6A	27	4
San Antonio Churchill	SACH	6A	28	4
Northside Clark	NOCL	6A	28	4
San Antonio Madison	SAMD	6A	28	4
Northside Marshall	NOMA	6A	28	4
San Antonio Roosevelt	SARO	6A	28	4
San Antonio Reagan	SARE	6A	28	4
Northside Brandeis	NOBR	6A	28	4
San Antonio Johnson	SAJO	6A	28	4
San Antonio LEE	SALE	6A	28	4
Northside Health Careers	NOHC	6A	29	4
Northside Holmes	NOHO	6A	29	4
Northside Jay	NOJA	6A	29	4
Northside Taft	NOTA	6A	29	4
Northside O'Connor	NOOC	6A	29	4
Northside Warren	NOWA	6A	29	4
Northside Stevens	NOST	6A	29	4
Northside Brennan	NBRE	6A	29	4
Northside Harlan	NSHA	6A	29	4
Northside Sotomayor	NSOT	6A	29	4
Laredo Alexander	LAAL	6A	30	4
Del Rio	DERI	6A	30	4
Laredo United	LAUN	6A	30	4
Laredo United South	LAUS	6A	30	4
Laredo Johnson	LAJH	6A	30	4
Eagle Pass	EAPA	6A	30	4
Edinburg	EDIN	6A	31	4
Edinburg North	EDNO	6A	31	4
La Joya	LAJO	6A	31	4
Mission	MISS	6A	31	4
Pharr-San Juan-Alamo	PSJA	6A	31	4
Edinburg Economedes	EDEC	6A	31	4
Brownsville Hanna	BRHA	6A	32	4
Harlingen	HARG	6A	32	4
Los Fresnos	LOFR	6A	32	4
Brownsville Rivera	BRRI	6A	32	4
San Benito	SABE	6A	32	4
Weslaco	WESL	6A	32	4



**2022-23 OFFICIAL DISTRICT ALIGNMENT
SPRING ATHLETICS
CONFERENCE 5A**

Region 1

Region 2

Region 3

Region 4

District 1

Canutillo
El Paso
El Paso Andress
El Paso Burges
El Paso Chapin
El Paso Jefferson

District 2

Clint Horizon
El Paso Bel Air
El Paso Del Valle
El Paso Hanks
El Paso Parkland
El Paso Ysleta

District 3

Amarillo
Amarillo Caprock
Amarillo Palo Duro
Amarillo Tascosa
Plainview

District 4

Abilene
Abilene Cooper
Abilene Wylie
Lubbock
Lubbock Cooper
Lubbock Coronado
Lubbock Monterey

District 5

Aledo
Azle
Granbury
Northwest
Saginaw
White Settlement Brewer
Wichita Falls Rider

District 6

Everman
Ft Worth Arlington Hts
Ft Worth North Side
Ft Worth Polytechnic
Ft Worth South Hills
Ft Worth Southwest
Ft Worth Trimble Tech
Ft Worth Wyatt

District 7

Argyle
Colleyville Heritage
Denton
Denton Ryan
Grapevine
Lake Dallas
N Richland Hills
Birdville
N Richland Hills
Richland

District 8

Arlington Seguin
Burleson
Burleson Centennial
Cleburne
Joshua
Mansfield Summit
Mansfield Timberview
Midlothian
Midlothian Heritage

District 9

Carrollton Creekview
Carrollton Smith
Carrollton Turner
Frisco
Frisco Lone Star
Frisco Reedy
Frisco Wakeland
Lewisville The Colony

District 10

Frisco Centennial
Frisco Emerson
Frisco Heritage
Frisco Independence
Frisco Lebanon Trail
Frisco Liberty
Frisco Memorial

District 11

Dallas Adams
Dallas Hillcrest
Dallas Jefferson
Dallas Kimball
Dallas Molina
Dallas South Oak Cliff
Dallas Sunset
Dallas White
Dallas Wilson

District 12

Dallas Adams
Dallas Conrad
Dallas Samuel
Dallas Seagoville
Dallas Spruce
Mesquite Poteet
North Mesquite
West Mesquite

District 13

Denison
Greenville
Lucas Lovejoy
McKinney North
Melissa
Princeton
Sherman

District 14

Corsicana
Crandall
Ennis
Forney
Lancaster
Red Oak
Terrell

District 15

Hallsville
Longview
Longview Pine Tree
Marshall
Mount Pleasant
Texarkana Texas
Tyler
Whitehouse

District 16

Dayton
Humble Kingwood Park
Huntsville
Lufkin
Nacogdoches
New Caney Porter

District 17

Baytown Goose Crk
Mem
Baytown Lee
Baytown Sterling
Crosby
Mt Belvieu Barbers Hill
Nederland
Port Arthur Memorial
Port Neches-Groves

District 18

Angleton
Friendswood
Galveston Ball
La Porte
Manvel
Santa Fe
Texas City

District 19

Galena Park
H Austin
H Carnegie Vanguard
H Madison
H Milby
H Northside
H Sharpstown
H Sterling
H Waltrip
H Wisdom

District 20

Fort Bend Kempner
Fort Bend Marshall
Fort Bend Willowridge
Lamar Fulshear
Richmond Foster
Richmond Randle
Rosenberg Lamar Cons
Rosenberg Terry

District 21

Brenham
Bryan Rudder
College Station
College Station A&M
Consolidated
Magnolia
Magnolia West
Montgomery
Montgomery Lake Creek

District 22

Belton
Killeen
Killeen Chaparral
Killeen Ellison
Killeen Shoemaker
Lake Belton
Waco
Waco University

District 23

Bastrop
Bastrop Cedar Creek
Elgin
Georgetown
Georgetown East View
Pflugerville
Pflugerville Connally
Pflugerville Hendrickson

District 24

Austin Ann Richards
Austin Crockett
Austin Eastside
Austin Johnson
Austin LASA
Austin McCallum
Austin Navarro
Austin Northeast
Austin Travis

District 25

Buda Hays
Cedar Park
Kyle Lehman
Leander
Leander Glenn
Leander Rouse
Liberty Hill
Lockhart

District 26

Boerne Champion
Comal Canyon
Comal Pieper
Comal Smithson Valley
Kerrville Tivy
SA Veterans Memorial
San Antonio Wagner
Seguin

District 27

SA Alamo Heights
SA Brackenridge
San Antonio Burbank
San Antonio Edison
San Antonio Highlands
San Antonio Houston
San Antonio Jefferson
San Antonio Lanier
San Antonio MacArthur

District 28

Castroville Medina
Valley
Eagle Pass Winn
SA SW CAST STEM HS
San Antonio Harlandale
San Antonio McCollum
San Antonio Southside
San Antonio Southwest
South San Antonio
Southwest Legacy

District 29

CC Carroll
CC Flour Bluff
CC Veterans Memorial
Corpus Christi King
Corpus Christi Miller
Corpus Christi Moody
Corpus Christi Ray
Gregory-Portland
Victoria East
Victoria West

District 30

La Joya Juarez-Lincoln
La Joya Palmview
Laredo Cigarroa
Laredo Martin
Laredo Nixon
Mission Veterans
Memorial
Rio Grande City
Roma

District 31

Edinburg Vela
McAllen
McAllen Memorial
McAllen Rowe
Mission Sharyland
Pharr Valley View
PSJA Memorial
PSJA North
PSJA Southwest
Sharyland Pioneer

District 32

Brownsville Lopez
Brownsville Pace
Brownsville Porter
Brownsville Veterans
Memorial
Donna
Donna North
Edcouch-Elsa
Harlingen South
Mercedes
Weslaco East



**2022-23 OFFICIAL DISTRICT ALIGNMENT
SPRING ATHLETICS
CONFERENCE 6A**

Region 1

Region 2

Region 3

Region 4

District 1

El Paso Americas
El Paso Coronado
El Paso Eastlake
El Paso Eastwood
El Paso El Dorado
El Paso Franklin
El Paso Montwood
El Paso Pebble Hills
El Paso Socorro

District 2

Midland
Midland Legacy
Odessa
Odessa Permian
San Angelo Central
Wolfforth Frenship

District 3

Crowley
Eules Trinity
Ft Worth Boswell
Ft Worth Paschal
FW Chisholm Trail
Hurst Bell
North Crowley
Weatherford

District 4

Haltom City Haltom
Keller
Keller Central
Keller Fossil Ridge
Keller Timber Creek
Northwest Eaton
Northwest Nelson
Southlake Carroll

District 5

Allen
Denton Braswell
Denton Guyer
Little Elm
McKinney
McKinney Boyd
Prosper
Prosper Rock Hill

District 6

Coppell
Lewisville
Lewisville Flower Mound
Lewisville Hebron
Lewisville Marcus Plano
Plano East
Plano West

District 7

Dallas Highland Park
Dallas Jesuit
Irving
Irving MacArthur
Irving Nimitz
Richardson
Richardson Berkner
Richardson Lake Highlands
Richardson Pearce

District 8

Arlington
Arlington Bowie
Arlington Houston
Arlington Lamar
Arlington Martin
Grand Prairie
South Grand Prairie

District 9

Garland
Garland Lakeview Cent
Garland Naaman Forest
Garland Rowlett
Garland Sachse
North Garland
South Garland
Wylie
Wylie East

District 10

Mesquite
Mesquite Horn
North Forney
Rockwall
Rockwall Heath
Royse City
Tyler Legacy

District 11

Cedar Hill
Dallas Skyline
De Soto
Duncanville
Mansfield
Mansfield Lake Ridge
Mansfield Legacy
Waxahachie

District 12

Bryan
Copperas Cove
Hutto
Killeen Harker Heights
Pflugerville Weiss
Temple
Waco Midway

District 13

Cleveland
Conroe
Conroe Caney Creek
Conroe Grand Oaks
Conroe Oak Ridge
Conroe The Woodlands
Conroe Woodlands College Park
New Caney
Willis

District 14

Houston Aldine
Houston Benjamin Davis Sr
Houston Eisenhower
Houston MacArthur
Houston Nimitz Spring
Spring Dekaney
Spring Westfield

District 15

Klein
Klein Cain
Klein Collins
Klein Forest
Klein Oak
Tomball
Tomball Memorial
Waller

District 16

Bridgeland
Cyp. Falls
Cyp. Lakes
Cyp. Park
Cyp. Ranch
Cyp. Springs
Cyp. Woods
Langham Creek

District 17

Cy-Fair
Cyp. Creek
Cyp. Ridge
Houston Memorial
Houston Northbrook
Houston Spring Woods
Houston Stratford
Jersey Village

District 18

H Bellaire
H Chavez
H Heights
H Lamar
H Math Sci. & Tech
H Westbury
H Westside

District 19

Katy
Katy Cinco Ranch
Katy Jordan
Katy Mayde Creek
Katy Morton Ranch
Katy Paetow
Katy Seven Lakes
Katy Taylor
Katy Tompkins

District 20

Fort Bend Austin
Fort Bend Bush
Fort Bend Clements
Fort Bend Dulles
Fort Bend Elkins
Fort Bend Hightower
Fort Bend Ridge Point
Fort Bend Travis
Richmond George Ranch

District 21

Beaumont United
Beaumont West Brook
Galena Park North Shore
Humble
Humble Atascocita
Humble Kingwood
Humble Summer Creek
Sheldon King

District 22

Channelview
Deer Park
Pasadena
Pasadena Dobie
Pasadena Memorial
Pasadena Rayburn
Pasadena South Houston

District 23

Alief Elsik
Alief Hastings
Alief Taylor
Alvin
Alvin Shadow Creek
Houston Strake Jesuit
Pearland
Pearland Dawson

District 24

Clute Brazoswood
Dickinson
Frndswd Clear Brook
Houston Clear Lake
LC Clear Creek
LC Clear Falls
LC Clear Springs

District 25

Austin Vandegrift
Cedar Park Vista Ridge
Manor
Round Rock
Round Rock McNeil
Round Rock Stony Pt.
Round Rock Westwood
RR Cedar Ridge

District 26

Austin
Austin Akins
Austin Anderson
Austin Bowie
Austin Lake Travis
Austin Westlake
Buda Johnson
Del Valle
Dripping Springs

District 27

Cibolo Steele
Converse Judson
New Braunfels
San Antonio E. Central
San Marcos
Schertz Clemens

District 28

Northside Brandeis
Northside Clark
Northside Marshall
San Antonio Churchill
San Antonio Johnson
San Antonio LEE
San Antonio Madison
San Antonio Reagan
San Antonio Roosevelt

District 29

Northside Brennan
Northside Harlan
Northside Health Careers
Northside Holmes
Northside Jay
Northside O'Connor
Northside Sotomayor
Northside Stevens
Northside Taft
Northside Warren

District 30

Del Rio
Eagle Pass
Laredo Alexander
Laredo Johnson
Laredo United
Laredo United South

District 31

Edinburg
Edinburg Economedes
Edinburg North
La Joya
Mission
Pharr-San Juan-Alamo

District 32

Brownsville Hanna
Brownsville Rivera
Harlingen
Los Fresnos
San Benito
Weslaco



PILOT PROGRAM- WHEELCHAIR DIVISION

Pilot program wheelchair division events for students in wheelchairs, boys and girls, to be held at the State Track & Field Meet:

- 100M Dash
- 400M Dash
- Shot Put

General Guidelines.

- The Wheelchair Division will include participants from any conference 1A-6A.
- The wheelchair racing and seated shot put events will be incorporated into the state meet schedule by UIL staff.
- The athletes in the Wheelchair Division will compete in separate races and field events from the traditional athletes.
- The top nine (9) performances that meet the UIL designated qualifying standards will advance to the State Championships.
- The events are considered a pilot program and will be non-scoring events, meaning these events will not count towards any team championships.
- The top three athletes in each event will receive medals. Athletes will be able to set state records at the state meet only.

Eligibility For Participation In The Wheelchair Division.

- Only high school students eligible under the UIL Constitution and Contest Rules Subchapter M are eligible to compete.
- All applicable UIL rules and regulations will apply.
- Any high school student may be eligible to participate in the Wheelchair Division track and field events with a documented permanent, physical disability. Each athlete's physical disability must be verified by a licensed physician and maintained on permanent file at the school.
- Schools and athletes are responsible for all aspects of participation in the events.

Wheelchair Division Qualification Standards. Participants must meet the following standard for each event in order to submit an entry to the state meet.

EVENT	BOYS	GIRLS
100M	:40	:45
400M	2:40	3:00
SHOT PUT	7'0" - 4K	7'0" - 6lbs.

Entry Requirements.

- Participants must submit a qualifying mark or performance to be considered for participation at the state event. Performances will only be accepted through the UIL website at www.uiltexas.org no later than midnight on April 28, 2018.
- If more than nine participants submit eligible entries in any event, the top 9 performances will qualify for the state meet.
- A qualifying performance may be obtained from any local competition during the regular season, district, area, regional or Paralympic events from spring 2018. Entries must be verified by official meet results.



Entry Procedures.

- School personnel will be required to submit verified qualifying performances.
- School personnel will be required to submit an official meet results document to verify the performance.
- A designated entry process will be provided on the UIL website www.uil texas.org and due no later than April 28, 2018.
- All state qualifiers will be posted on the UIL website at the time they become available.

100m, 400m Wheelchair Equipment and Racing Standards. Athletes will be expected to compete in their school's team uniform. Reasonable accommodations will be made when necessary. Resources for track and field equipment information can be obtained from the following link:

<http://www.texasregionalparalympicsport.org>

- Manual wheelchairs only for track events, which may be specialized racing chair or an all sport chair.
- The racing chair may have two large wheels (not to exceed 70cm in diameter) and one small wheel (not to exceed 50cm in diameter).
- The racing chair must be manually propelled by pushing on the wheels or the hand rims. The chair shall not be equipped with gears, levers or electronic steering.
- All participants must wear a racing helmet that is a hard protective shell and should meet the safety standards of the American National Safety Institute (ANSI).
- Shoes are not required, however protective socks are recommended.
- All participants must start each event using racing gloves.
- Athletes' lower limb(s) must be secured to the track chair. Any touch of the ground by a lower limb results in disqualification from the event.
- Competitors are responsible for the proper functioning of the competition chair and equipment. Athletes that experience an equipment failure may finish the event; however, no event will be delayed or rescheduled if such an incident occurs.

Shot Put Equipment And Seated Throwing Standards. Athletes will be expected to compete in their school's team uniform. Reasonable accommodations will be made when necessary. Resources for track and field equipment information can be obtained from the following link:

<http://www.texasregionalparalympicsport.org>

- Implements shall meet NFHS regulations. The 4K shot put will be used for boys and 6lbs. shot put for girls.
- All participants must put the shot from a "chair" (manual wheelchair, throwing chair, power wheelchair). Scooters and "standing chairs" will not be allowed. Chairs may be designed based on the needs of the athlete.
- The upper most part of the cushion/seat on any chair may not exceed 75cm (29.5 inches) measured from the ground. The seat of the chair has to be square or rectangular and flat or sloped backwards.
- The chair may not have any moving parts or articulated joints.
- No part of the throwing frame or wheelchair may be outside of the circumference of the circle.
- The chair will be considered an extension of the athlete's body. For example: Any part of the chair touching the top of the stop board is a foul.
- A coach (only) may assist the athlete in getting to the competition area.
- A coach (only) may assist the athlete in entering and exiting the circle.
- Tie-down straps for the chair are recommended and should be provided by the athlete; however, a coach (only) may hold the chair during the throwing attempt to prevent excessive movement if no straps are available.
- The athlete's body must remain in contact with the seat during the throw.



Frequently Asked Questions.

1. Who is eligible to compete in the Wheelchair Division?

All athletes with a permanent physical disability on file with the school and in grades 9-12 who meet the eligibility standards in the C&CR Subchapter M may be eligible. The mobility of a student participant may or may not include or require the full time use of a wheelchair.

2. Where can athletes with physical disabilities compete?

Wheelchair events may be held at any UIL sanctioned meet. Performances at meets held by groups, including the Paralympic events, could be accepted as qualifying marks for state meet entries provided the performance can be verified with official meet results and/or verification provided by the meet host. Resources for track and field meet event information can be obtained from the link: www.texasregionalparalympicsport.org

3. How does an athlete in wheelchair participate for their high school track and field team?

The athlete must follow the same procedures at their school established for traditional athletes competing in track and field.

4. Can wheelchair contestants compete against traditional athletes in the same race?

Yes, in the 100m and 400m it is recommended that if this occurs the wheelchair athlete is designated to compete in the inside lane. Wheelchair athletes are coached to finish any race by following the curve of the track and need more than 20m to stop forward motion. Boys and girls heats may be combined for competition and separated at the conclusion to determine results and places for each gender and/or division.

5. Can wheelchair contestants compete against traditional athletes in the shot put?

Yes, the wheelchair athletes may be flighted with the traditional athletes for the seated shot put throw. Physically challenged participants may choose to take all throws after entering the ring. The athlete's choice of type of "throwing chair" may determine if this is possible or if the athlete needs to be flighted before or after the traditional athletes.

6. How does a coach enter an athlete in the state meet?

The athlete must be entered into the state meet through an online entry form available on the track page on the UIL website. Performance results will be required in order to complete the online entry process.

7. Can athletes racing on the track receive assistance from coaches or other personnel?

No, athletes may only propel themselves forward through their own pushing of the wheels or hand rims.

8. Can athletes throwing the shot put receive assistance from the coaches or other personnel?

A coach (only) may assist the athlete in getting to the competitive area and may also assist the athlete in entering and leaving the circle. Also, for throwing events, the athlete should provide tie-down straps. When no straps are available, a coach may hold the chair during the throwing attempt to prevent excessive movement.

9. Are the uniform rules in place for an athlete in a wheelchair?

Yes, all uniform rules and regulations are in effect just as with the traditional athletes. Some exceptions may need to be considered and presented to meet officials for clarification.

10. Who is responsible for the athlete's equipment?

The athlete is responsible for needed equipment. Schools may provide equipment and assistance may be available through Texas Regional Paralympic Sport upon request. Resources for track and field equipment



NO PURSES. NO BAGS.

NEISD BAC PURSE/BAG POLICY



Prohibited Bags

PROHIBITED ITEMS INCLUDE, BUT ARE NOT LIMITED TO:

- All purses, bags or containers larger than a small clutch bag
- Backpacks
- Binocular case – Binoculars may be worn around the neck
- Briefcases
- Camera bags
- Cinch bags
- Computer bags
- Coolers
- Fanny packs
- Luggage of any kind



Approved Bags

CLEAR TOTE
Plastic, vinyl or PVC –
not exceeding 12" x 6" x 12"

PLASTIC STORAGE BAG
Clear, one (1) gallon,
re-sealable

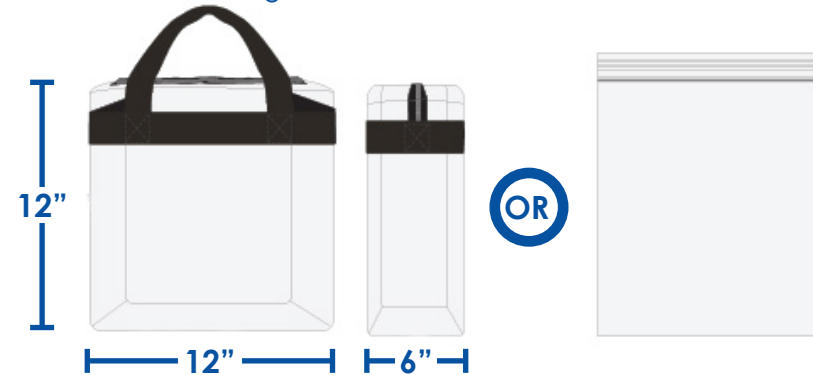

SMALL CLUTCH PURSE

Approximately the size of your hand, but absolutely no larger than 5.5" x 8.5" (see our small guide sheet) with or without a handle or strap. Can be carried separately or within an approved plastic bag shown above.



Exceptions will be made for:

- Bags for medically necessary items
- News media equipment (for credentialed media)
- Official team and other field photographers
- Booster clubs selling items
- Diaper bags

All bags are subject to inspection prior to entry regardless of size or type.

REGION IV TRACK & FIELD MEET 2022 - 4/29/2022 to 4/30/2022**North East ISD - Heroes Stadium****REGION IV - Records**

501	Women 3200 Meter Run 5A	10:31.22	4/29/2022	Isabel Conde De Frankenberg - Cedar Park
502	Men 3200 Meter Run 5A	9:09.68	4/23/2021	Foster Wilfong - Boerne Champion
503	Women 4x100 Meter Relay 5A	46.75	2017	Austin Johnson - Austin Johnson D Gilbert, R Horowitz, S Porter, H Porter
504	Men 4x100 Meter Relay 5A	41.08	4/27/2018	ANGLETON - ANGLETON E HAWKINS, C Bowie, M Ross, T Williams
505	Women 800 Meter Run 5A	2:06.53	4/30/2022	Isabel Conde De Frankenberg - Cedar Park
506	Men 800 Meter Run 5A	1:53.12	2015	Reagan Olguin - Edinburg Vela
507	Women 100 Meter Hurdles 5A	14.53	2013	Autymn Scales - Brennan
508	Men 110 Meter Hurdles 5A	14.20	2013	Jonathan Jefferson - SA Highlands
509	Women 100 Meter Dash 5A	11.80	2004	Gyiasa Hall - Austin Reagan
510	Men 100 Meter Dash 5A	10.50	4/29/2022	Corin Burns - Georgetwn E View
511	Women 4x200 Meter Relay 5A	1:40.10	4/30/2022	Buda Johnson - Buda Johnson S Kinnison, S Silas, S Olivarez, E Sanchez
512	Men 4x200 Meter Relay 5A	1:26.20	2013	Corpus Christi Flour Bluff - CC Flour Bluff R Mendoza, J Pradia, A Dilworth, T Martin
513	Women 400 Meter Dash 5A	55.52	4/27/2018	Bailey Goggans - Marble Falls
514	Men 400 Meter Dash 5A	47.81	2013	Steven Champlin - Medina Valley
515	Women 300 Meter Hurdles 5A	42.36	4/30/2022	Sidney Kinnison - Buda Johnson
516	Men 300 Meter Hurdles 5A	37.88	2008	Andre Sanders - Cedar Park Vista
517	Women 200 Meter Dash 5A	20.62	2017	Caroline Anyatonwu - Austin Johnson
518	Men 200 Meter Dash 5A	21.20	4/30/2022	Corin Burns - Georgetwn E View
519	Women 1600 Meter Run 5A	4:49.31	4/30/2022	Isabel Conde De Frankenberg - Cedar Park
520	Men 1600 Meter Run 5A	4:11.69	4/30/2022	Ayden Granados - McAllen Memorial
521	Women 4x400 Meter Relay 5A	3:50.94	4/27/2019	Boerne Champion - Boerne Champ L Bolli, H Stadler, R Burkey, A Gonzales
522	Men 4x400 Meter Relay 5A	3:17.61	2017	Victoria West - Victoria West J Smith, J Ventura, K Freeman, T Ogden
523	Women Discus Throw 5A	156-09	1979	Dana Olson - Austin Westlake
524	Men Discus Throw 5A	199-00	2002	Derek Randall - Beeville Jones
525	Women High Jump 5A	6-00	1993	Amy Acuff - C C Calallen
526	Men High Jump 5A	6-11	1998	Ryan Harlan - Waco Midway
527	Women Long Jump 5A	20-00.75	2005	Brandi Stanfield - Pflugerville Connally
528	Men Long Jump 5A	23-11.50	1995	Tanyana McCray - Flour Bluff
529	Women Pole Vault 5A	13-09	4/27/2018	Riley Floerke - GREGORY-PORTLAND
530	Men Pole Vault 5A	16-03.50	2008	Kaleb Sharder - Gregory-Portland
531	Women Shot Put 5A	50-01	1999	Ibie Benido - C C Calallen
532	Men Shot Put 5A	65-02.50	1987	Lance Wilson - Pflugerville
533	Women Triple Jump 5A	41-09.75	2005	Brandi Stanfield - Pflugerville Connally
534	Men Triple Jump 5A	48-07.50	2017	Vonte Davis - Rosenberg Terry
601	Women 3200 Meter Run 6A	10:18.37	2015	Devin Clark - Smithson Valley
602	Men 3200 Meter Run 6A	8:59.14	4/29/2022	Kevin Sanchez - Aus Vandergrift
603	Women 4x100 Meter Relay 6A	45.60	4/24/2021	San Antonio Reagan - Reagan M McElroy, T Wise, A Quinones Mixon, J Montgomery
604	Men 4x100 Meter Relay 6A	40.98	2017	Converse Judson - Judson J West, C Mills II, S Richburg, K Morgan
605	Women 800 Meter Run 6A	2:10.42	4/24/2021	Amity Ebarb - Weslaco
606	Men 800 Meter Run 6A	1:49.68	2017	Sam Worley - Canyon
607	Women 100 Meter Hurdles 6A	14.19	2013	Jerica Love - NS Warren
608	Men 110 Meter Hurdles 6A	13.88	2016	Josh McGowen - McAllen
609	Women 100 Meter Dash 6A	11.36	4/29/2022	Saniya Friendly - Schertz Clemens
610	Men 100 Meter Dash 6A	10.43	4/27/2019	Jose Garcia - Harlingen
611	Women 4x200 Meter Relay 6A	1:37.36	2015	Converse Judson - Judson K James, M Kuykendoll, K Pickens, K Horton
612	Men 4x200 Meter Relay 6A	1:24.83	2017	Converse Judson - Judson J West, C Mills II, S Richburg, K Morgan
613	Women 400 Meter Dash 6A	54.53	4/30/2022	Ariana Sutton - Schertz Clemens

REGION IV TRACK & FIELD MEET 2022 - 4/29/2022 to 4/30/2022**North East ISD - Heroes Stadium****REGION IV - Records**

614	Men 400 Meter Dash 6A	47.26	2016	Jon Maas - Clark
615	Women 300 Meter Hurdles 6A	42.14	4/29/2022	Taylen Wise - SA Reagan
616	Men 300 Meter Hurdles 6A	36.39	4/27/2018	Tre'Bien Gilbert - JUDSON
617	Women 200 Meter Dash 6A	23.52	2015	Kiana Horton - Judson
618	Men 200 Meter Dash 6A	20.93	2013	Cameron Williams - SA Johnson
619	Women 1600 Meter Run 6A	4:45.91	2015	Devin Clark - Smithson Valley
620	Men 1600 Meter Run 6A	4:09.00	2016	Samuel Worley - Canyon
621	Women 4x400 Meter Relay 6A	3:46.11	2015	Converse Judson - Judson M Kuykendoll, Z Dickerson, T Mack, D Gibson
622	Men 4x400 Meter Relay 6A	3:15.16	2014	Converse Judson - Converse Judson C Johnson, J Lewis, R Reece, B Sanders
623	Women Discus Throw 6A	155-01	4/27/2018	Sadey Rodriguez - LAREDO UNITED
624	Men Discus Throw 6A	192-11.50	1983	David Stanley - Angleton
625	Women High Jump 6A	6-00	2010	Michaela Palu - SA Marshall
626	Men High Jump 6A	7-02	1990	Russell Garcia - Alice
627	Women Long Jump 6A	20-04	1993	Tameka Roberts - CC Moody
628	Men Long Jump 6A	24-06	1959	Dudley Haas - CC Ray
629	Women Pole Vault 6A	13-02	2014	Sara Kathryn Stevens - New Braunfels
630	Men Pole Vault 6A	16-06	4/29/2022	Jack Mann - Austin Lake Trav
631	Women Shot Put 6A	46-01.50	2009	Taylor Rosser - Converse Judson
632	Men Shot Put 6A	72-06.25	2009	Stephen Saenz - Rio Grande City
633	Women Triple Jump 6A	41-08.75	4/29/2022	Iyanna Webb - NS Harlan
634	Men Triple Jump 6A	49-00.50	4/26/2019	Rashod Owens - Roosevelt
701	Women 100 Meter Dash WC WC	22.00	4/27/2019	Susana Swanson - McAllen Memorial
702	Men 100 Meter Dash WC WC	17.79	2016	Joe Solis - Weslaco
703	Women 400 Yard Dash WC WC	1:25.17	4/30/2022	Elicia Meairs - NS Stevens
704	Men 400 Yard Dash WC WC	1:01.64	4/30/2022	Carlo Uglow - Buda Hays
705	Women Shot Put WC WC	18-08.75	4/29/2022	Elicia Meairs - NS Stevens
706	Men Shot Put WC WC	17-04	2017	Bryan Prado - C C Veterans Mem